

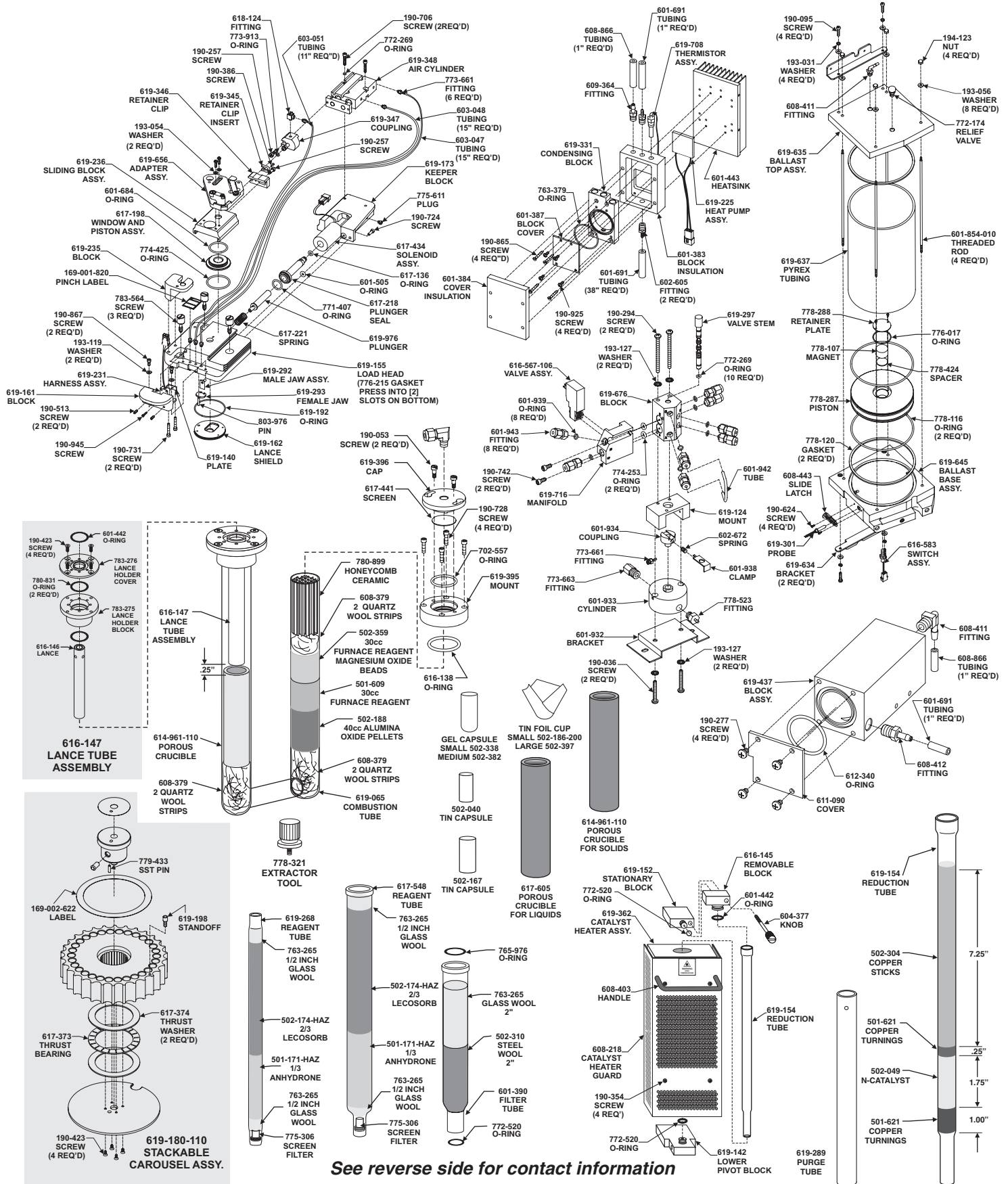

TruSpec Consumables & Spares Reference Card

Note: Part numbers and standards' values may change. Consult LECO for the latest information.



See reverse side for contact information

GENERAL COMBUSTION SUPPLIES

502-188 Alumina Oxide Pellets 200 g bottle
501-171-HAZ Anhydrous 454 g (1 lb.) bottle
502-189 Copper Sticks 100 g ampule
502-304 Copper Sticks 100 g bottle
502-304-500 Copper Sticks 500 g bottle
501-621 Copper Turnings 200 g bottle
501-609 Furnace Reagent (Calcium Oxide/Kaolin)
501-081 Glass Wool 454 g (1 lb.) box
763-265 Glass Wool 227 g (0.5 lb.) package
501-077 Iron Chip 908 g (2 lb.) bottle
502-174-HAZ Lecosorb 500 g bottle
502-359 Magnesium Oxide Beads 200 g
502-049 N-Catalyst 50 g bottle
608-379 Quartz Wool Strips 10/pk
502-310 Steel Wool 454 g (1 lb.)

CAPSULES AND CRUCIBLES

502-338 Gel Capsule, Small 400/pkg
502-382 Gel Capsule, Medium 400/pkg
614-961-110 Porous Crucibles for solids 10/pk (use only with 614-962 lance)
617-605 Porous Crucibles for liquids 10/pk
501-059 Tin Capsules 100/bottle
502-040 Tin Capsules 100/bottle
502-040-100 Tin Capsules 1000/bottle
502-167 Tin Capsules, Large 100/bottle
502-186-200 Tin Foil Cups, Small 100/bottle
502-186-100 Tin Foil Cups, Small 1000/bottle
502-397 Tin Foil Cups, Large 100/bottle
502-397-400 Tin Foil Cups, Large 400/bottle

OPERATION ACCESSORIES

502-005 Brush
601-981 Wire Brush
616-152 Crucible Extractor Tool
775-306 Secondary Filter, 10 micron
775-307 Filter Tool, Thumbscrew
502-023 Funnel Quick Disc
778-321 Lance Extraction Tool
502-213 Leak Detection Solution
601-470-110 Liquid Injector Kit, Manual
603-350 Tool O-ring Installation
762-515 Tool O-ring Removal
616-504 Particle Filter
604-398 Sample Cup Holder, Large
604-373 Sample Cup Holder, Small
601-490-110 Sample Foiler Kit
778-405 10-Sample Storage Block
501-614 Spatula
619-180-110 Stackable Carousel Assembly
502-007 Tube Cleaner
502-028 Tweezers
604-378 Tweezers, Curved
501-241 Vacuum Grease
619-380 Vacuum Cleaner Attachment Assembly
619-377 Bypass Plate

COMBUSTION TUBES AND GLASSWARE

601-390 Glass Filter Tube (wide mouth top, small bottom) requires one (1) 765-976 Top O-ring and one (1) 772-520 Bottom O-ring for sealing
771-030 Glass Filter Tube (small mouth top and bottom) requires 772-520 O-rings for sealing
775-601 Reagent Tube, requires 772-520 O-rings for sealing
601-437 Reduction Tube, requires 601-442 O-rings for sealing
780-899 Honeycomb Ceramic Stop
619-065 Combustion Tube
617-441 Screen Filter
502-450 Quartz Filter

*Values vary—contact LECO for current levels.

NOTE: Part numbers and standards' values may change.
Consult LECO for latest information.

United States:

Ph: 1-800-292-6141

Fax: 269-982-8977

Canada:

Ph: 1-800-268-0215

Fax: 905-564-6582

represented by:

Other Countries:

Ph: 269-983-5531

Fax: 269-983-3850

SET-UP STANDARDS

SOY FLOUR (250 grams)

Part No.	% C	% H	% N	% S
501-561	—	—	8.0–10.0	—

CORN FLOUR (250 grams)

Part No.	% C	% H	% N	% S
501-563	—	—	0.8–1.6	—

ORCHARD LEAVES (20 grams)

Part No.	% C	% H	% N	% S
502-055	44.0–52.0	5.7–6.5	2.0–2.8	0.15–0.25

SOIL (65 grams)

Part No.	% C	% H	% N	% S
502-062	0.75–1.25	*	*	*
502-308	2.50–3.50	—	*	*
502-309	10.0–14.0	—	*	*

TOBACCO LEAVES (20 grams)

Part No.	% C	% H	% N	% S
502-082	35.0–47.0	4.0–7.0	2.0–4.0	0.3–0.8

EDTA (50 grams)

Part No.	% C	% H	% N	% S
502-092	40.80–41.20	5.46–5.54	9.52–9.60	—

EDTA (250 grams)

Part No.	% C	% H	% N	% S
502-092-250	40.80–41.20	5.46–5.54	9.52–9.60	—

GLYCINE (50 grams)

Part No.	% C	% H	% N	% S
502-211	32.00	6.67	18.66	—

CORN GLUTEN (50 grams)

Part No.	% C	% H	% N	% S
502-272	51.0–53.0	7.0–7.5	11.0–12.0	0.75–1.0

ALFALFA (50 grams)

Part No.	% C	% H	% N	% S
502-273	45.0–47.0	5.5–6.5	2.5–5.0	0.25–0.35

WHEAT FLOUR (50 grams)

Part No.	% C	% H	% N	% S
502-274	44.0–46.0	6.0–7.0	2.5–3.5	0.15–0.25

RYE FLOUR (50 grams)

Part No.	% C	% H	% N	% S
502-275	43.5–45.5	6.0–7.0	1.5–2.5	0.10–0.20

OAT MEAL (50 grams)

Part No.	% C	% H	% N	% S
502-276	45.0–47.0	6.0–7.0	2.5–3.5	0.15–0.25

BARLEY (50 grams)

Part No.	% C	% H	% N	% S
502-277	45.0–47.0	6.0–7.0	1.0–3.0	0.10–0.20

RICE FLOUR (50 grams)

Part No.	% C	% H	% N	% S
502-278	43.0–45.0	6.0–7.0	1.0–3.0	0.10–0.20

SUCROSE (50 grams)

Part No.	% C	% H	% N	% S
501-441	42.10	6.48	—	—

REFERENCE MATERIALS

COAL PROX-PLUS (50 grams)

Part No.	Desc.	% C	% H	% N
502-442	Low	75.3	4.9	1.1
502-443	Medium	69.4	5.1	1.1
502-444	High	78.7	5.4	1.48

COKE PROX-PLUS (50 grams)

Part No.	Desc.	% C	% H	% N
502-452	Prox Plus	93.3	3.94	1.43